

INDEX

• Frames assembly	2
• Track / sill support steel assembly	3
• Mechanism assembly	4
• Fixing frames to wall	5
• Details of fixing the frame square to wall.....	6
• Assembly of panels	7
• Panels adjustment	8
• Adjustment of the door panels	9
• Assembly of the door spring closer	10
• Lock adjustment	11
• Adjustment of lock with the skate	12

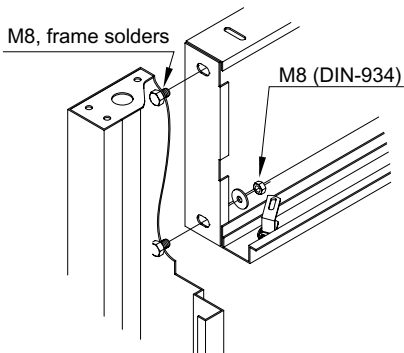

Detail A: Frame fixing to mechanism.

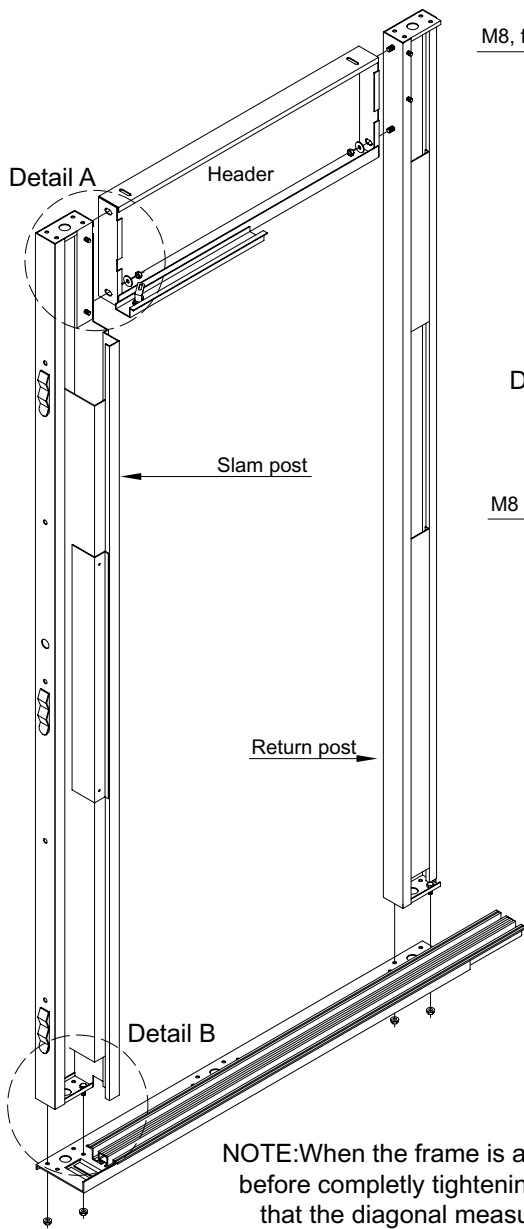
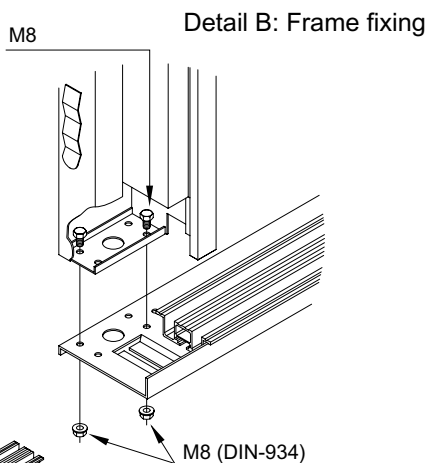

Detail B: Frame fixing

NOTE: When the frame is assembled, before completely tightening, check that the diagonal measurements (A and B), are equal.

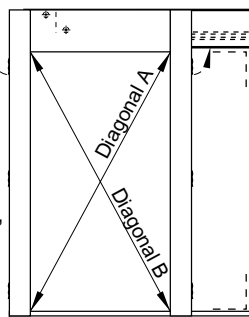

Track/sill support steel to sill fixings.

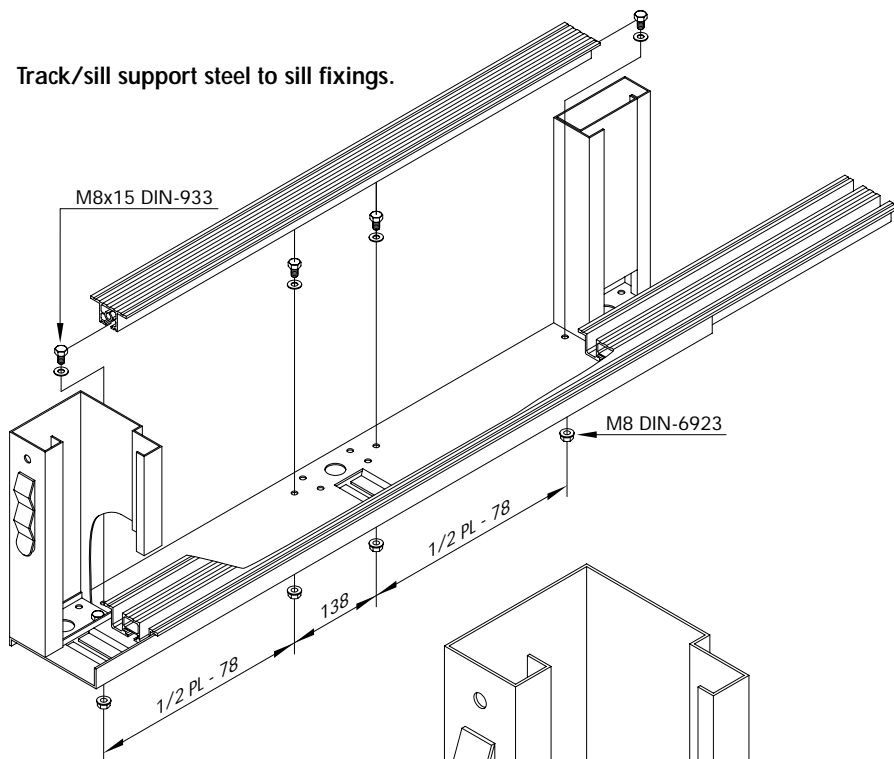

Lateral fixing of the track/sill to the frame post.
(The fixing is the same on both posts).

Ø8 DIN-933
M8x15 DIN-933

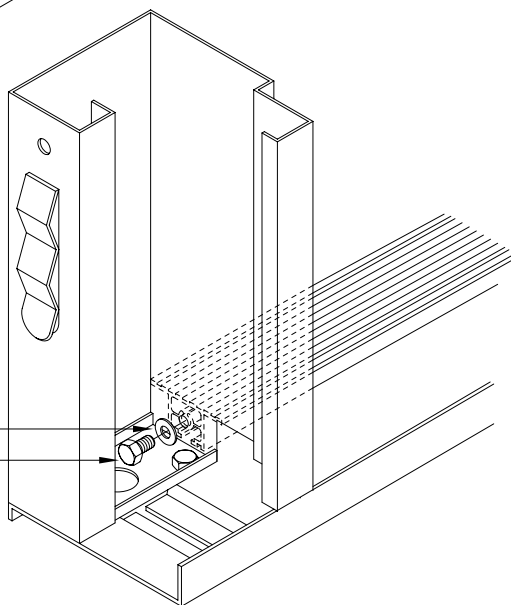

Connection of mechanism to frame.
First place the interlock rod into the angle bracket fitted to the emergency release unit.
Fit the track assembly into screws A, then swing the track assembly into screws B.
Tighten nuts.

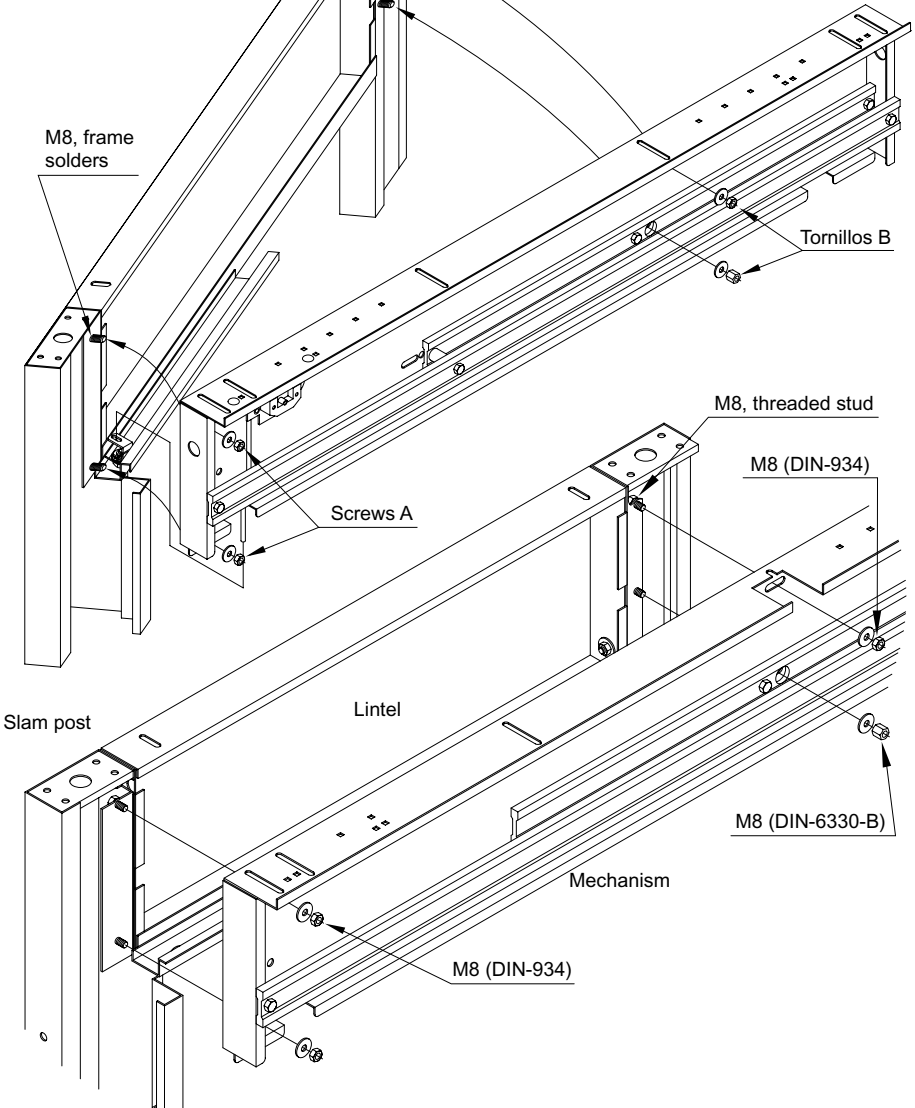

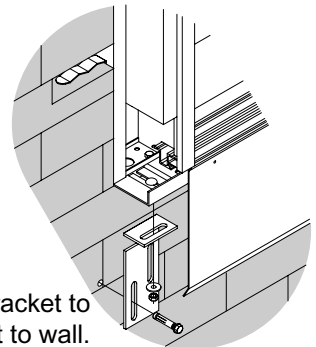
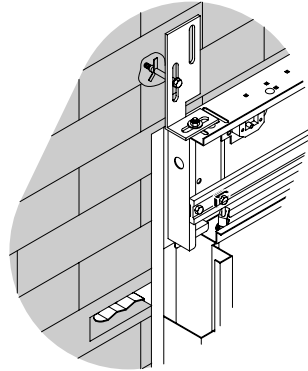
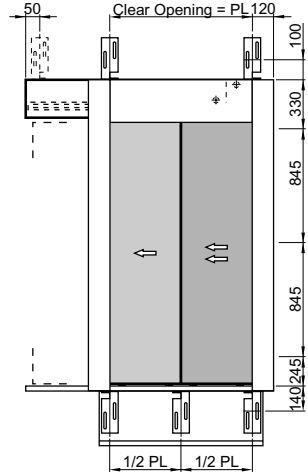
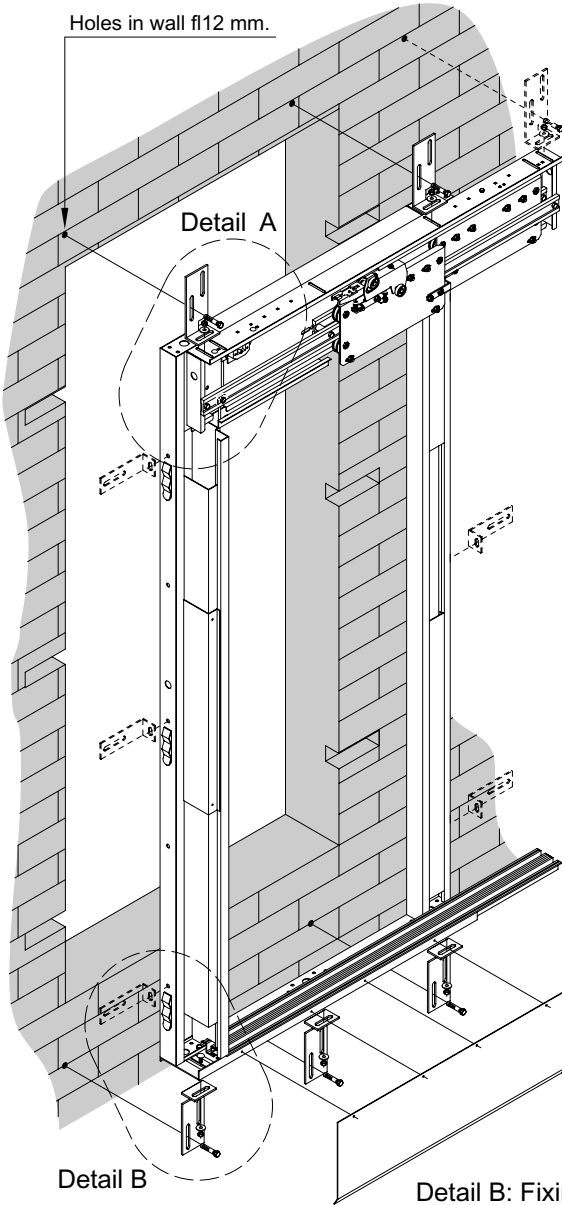

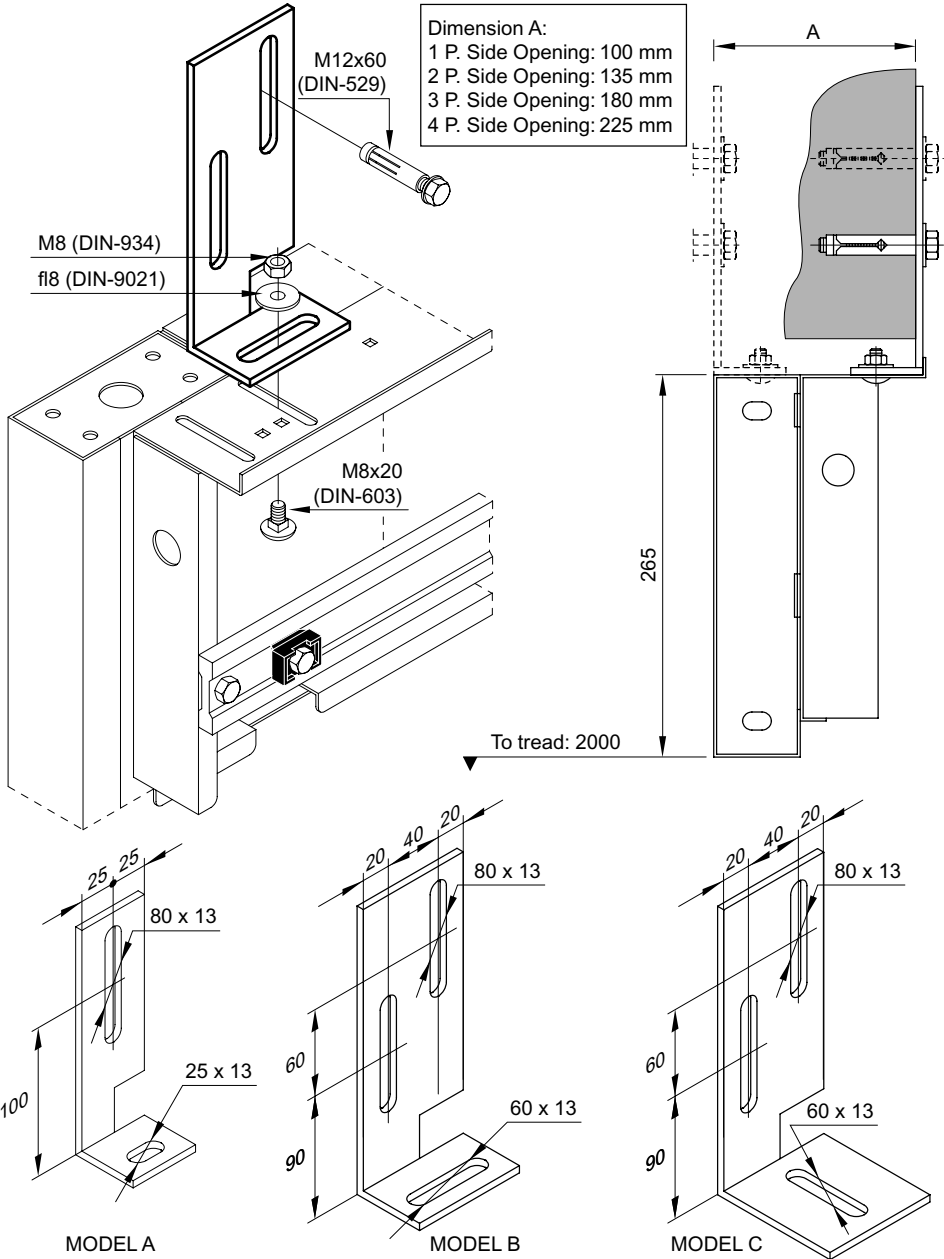

Detail C: Fitting flame stop angle.
There should be an overlap of 5 mm between the slow panel and fast panel as shown in detail C.

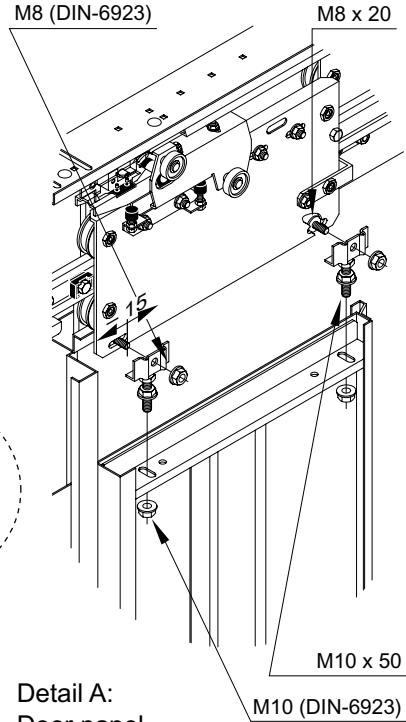
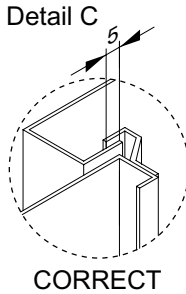
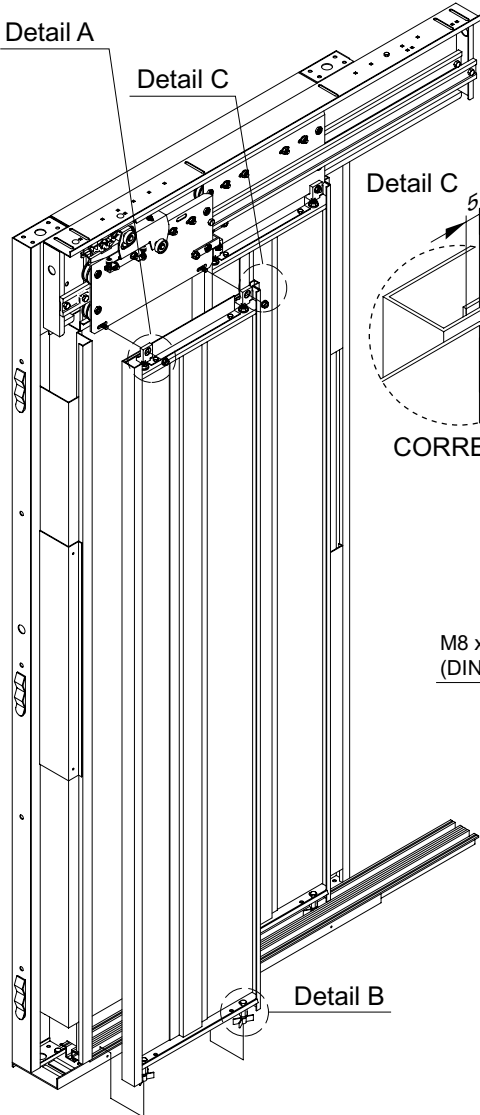

Detail A:
Door panel
fixing to the hanger.

M8 x 15
(DIN-933)

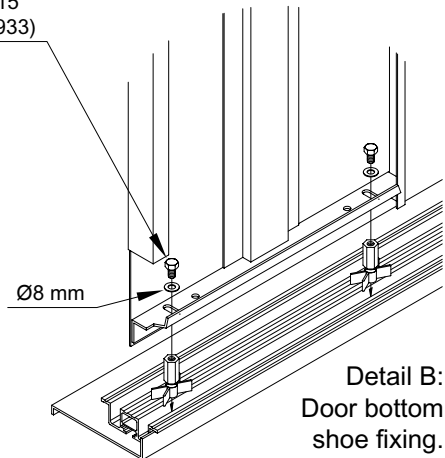

Detail B:
Door bottom
shoe fixing.

Panel adjustment:(With the doors fully open). When the slow panel is suspended on the hanger move it until it remains on flush with the front edge of the return post. Tighten the nuts that hold the hanger to the suspension bolt. Adjust the panel by means of the nuts (B) on the suspension bolt until the panel is completely parallel to the return post. Also check that there is a distance of 5 mm between the sill and the bottom of the door panel. Do the same with the fast panel.

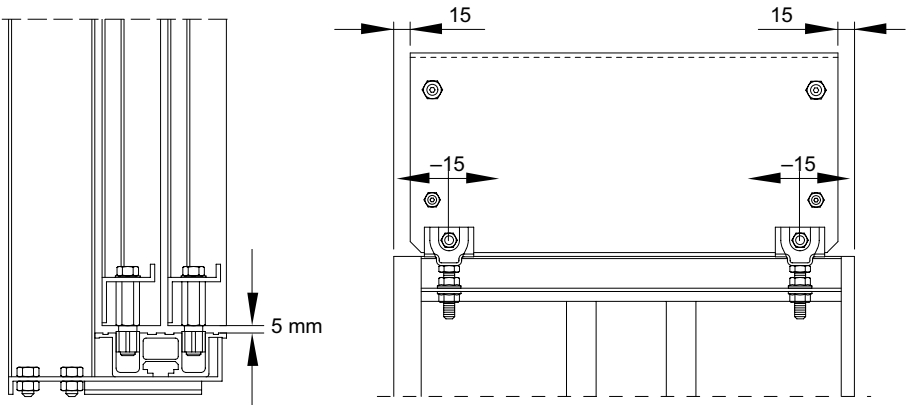
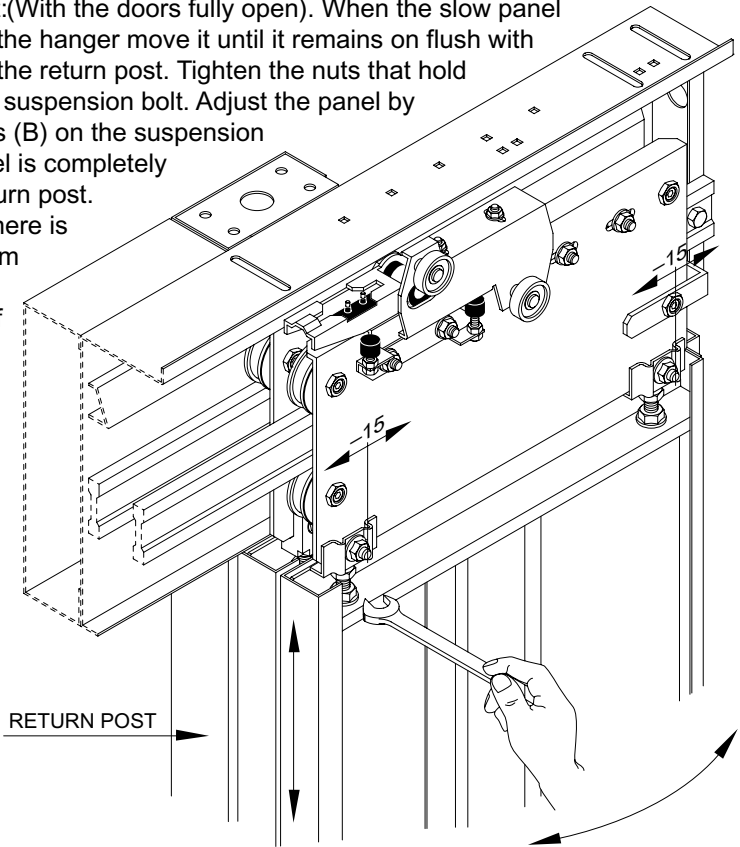

CORRECT



INCORRECT

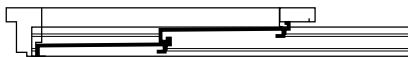

The panel positions are correct when they slide parallel to the sill/track. If for any reason the panels do not slide smoothly follow these instructions:

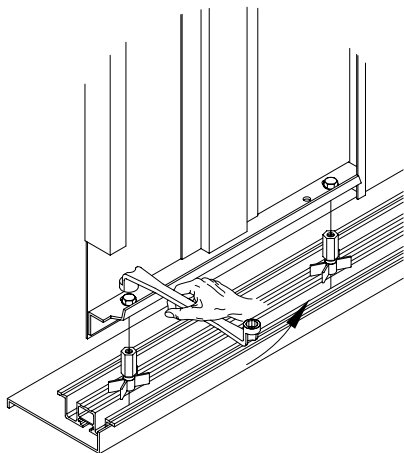

1st.: Take out the door bottom shoes.

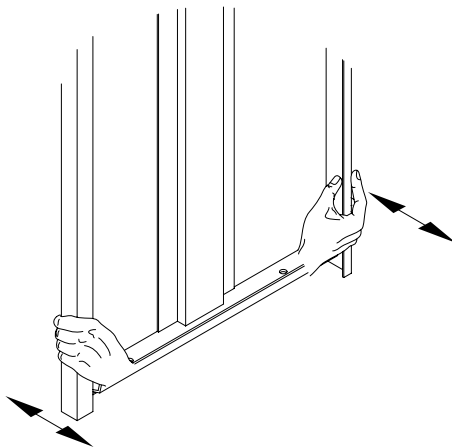

2nd.: Slightly straighten the panel.

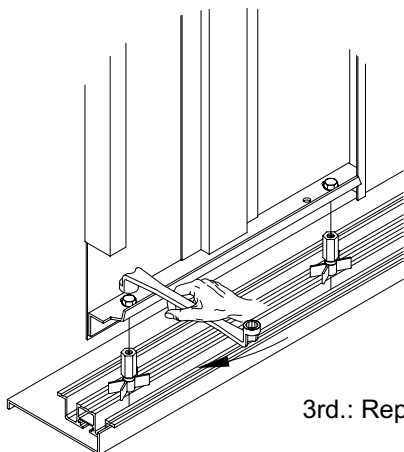

3rd.: Replace door bottom shoes.

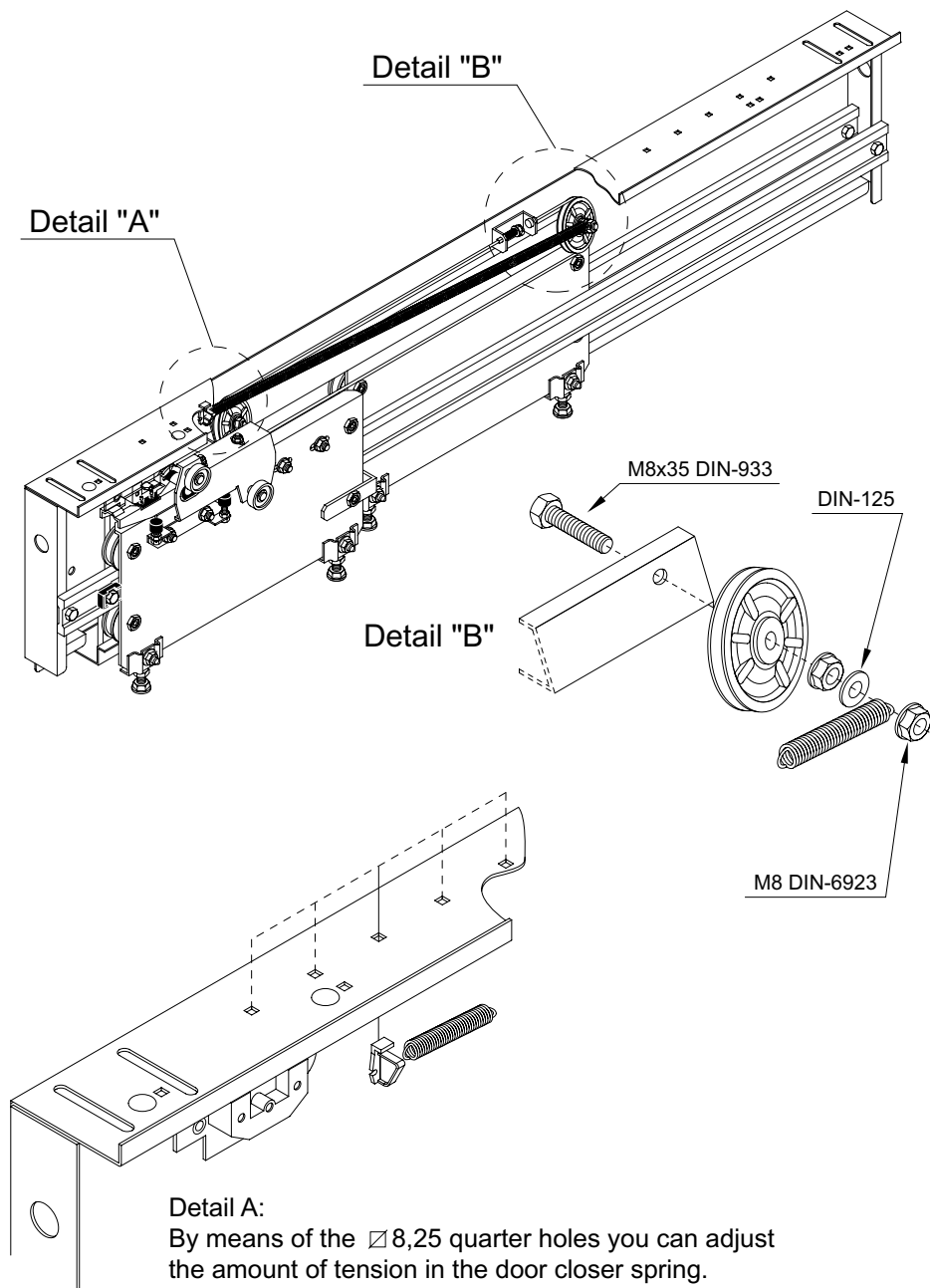

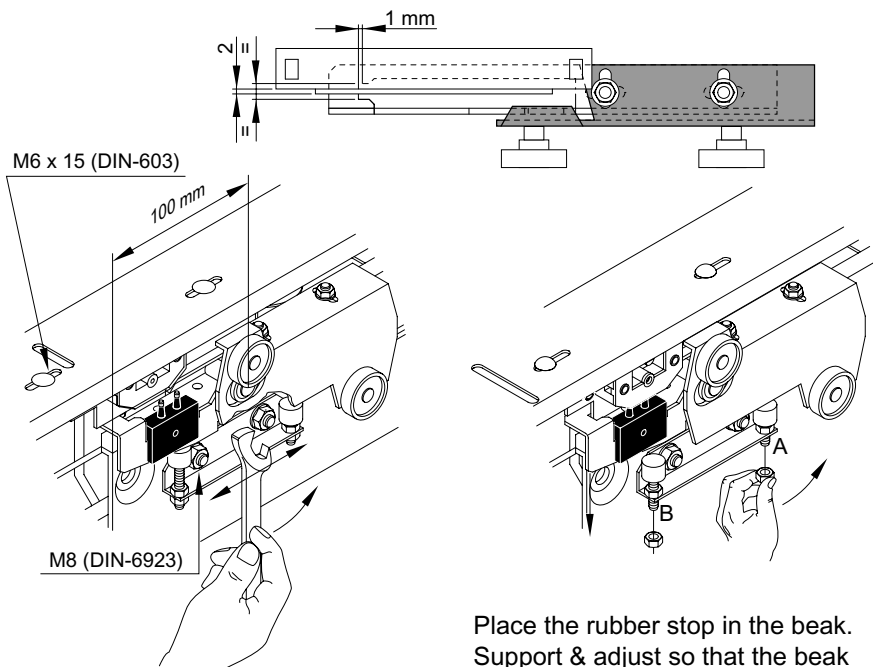
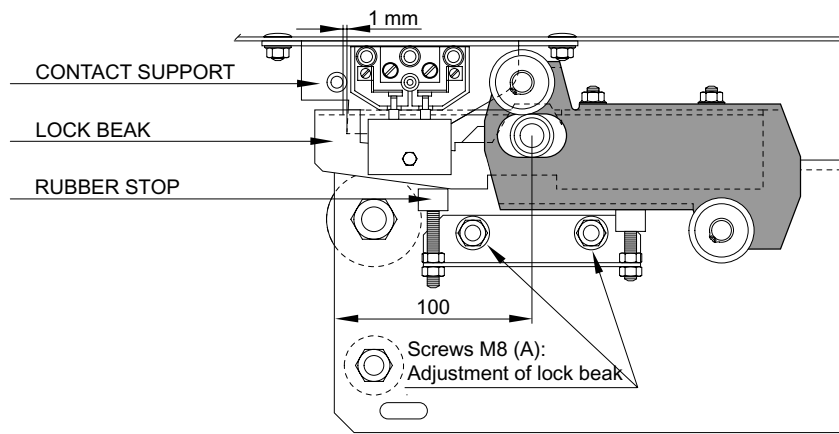

Using the two screws (M8) adjust the lock beak until the centre of the pivot pin is 100 mm from the leading edge of the hanger.

Place the rubber stop in the beak. Support & adjust so that the beak remains in the horizontal position when locked. Then adjust rubber stop (B) mb leaving sufficient clearance for the beak to clear the lock when opening.

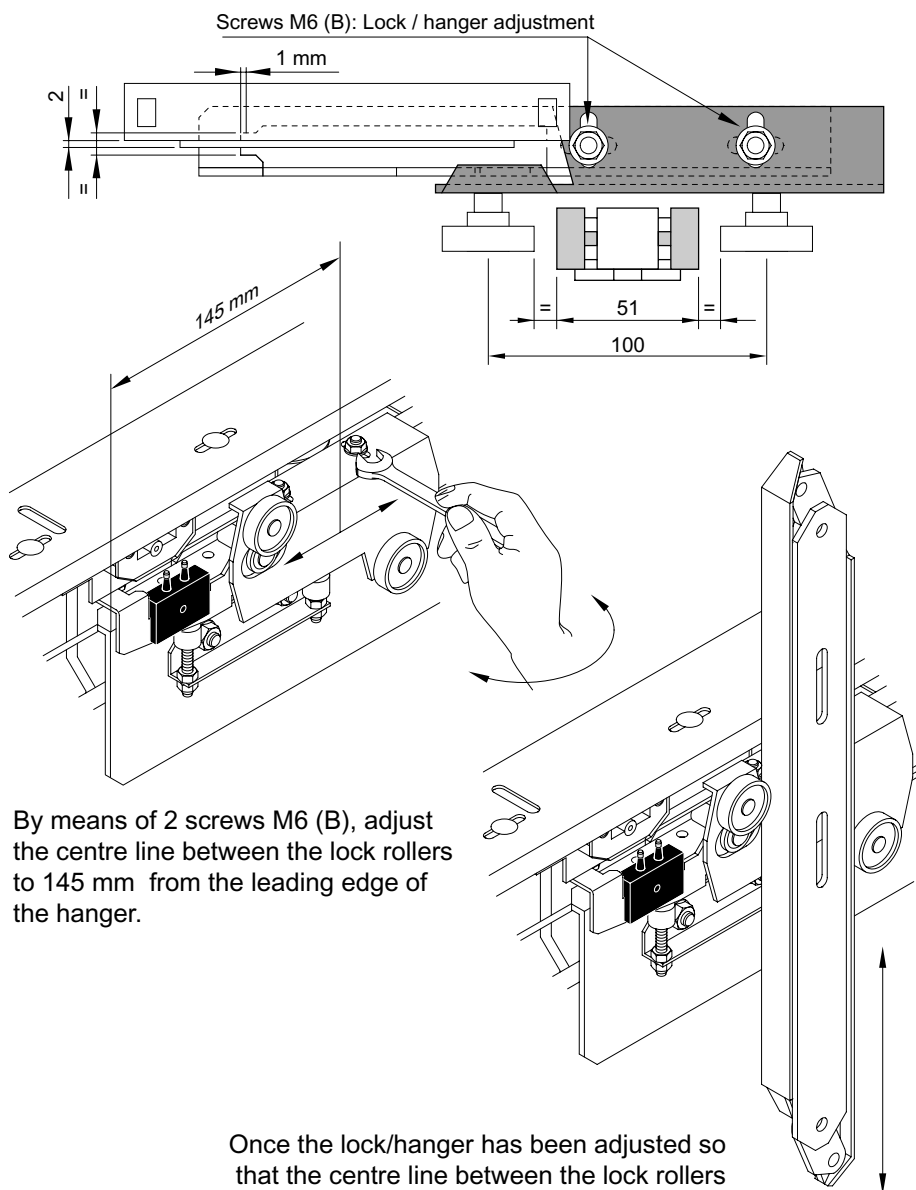

ATTENTION

It is advisable that in the process of maintenance of the door, the following points should be carried out in order to assure the correct functioning of the installed operator:

1st) NEVER grease the guides or rotation rails as the dirt and dust form a thick layer of grease that stops and obstructs the movements of the panels.

2nd) The rotation wheel, if dirty, produces the same negative effect as above mentioned and free of objects of any kind in sliding guide to avoid any possible interferences that could stop or block the panels.

3rd) Maintain the inside of the aluminium tread clean of the sliding canals in order to avoid possible interferences that slow down or block the panels.

NECESSARY TOOLS

- Spanners: 2 x 8 / 2 x 10 / 13 / 17 / 19 / 24.
- Tubular Wrench: 10 / 13 / 17.
- Hexagonal allen wrenches: 3 / 4 / 5 / 6.
- Screwdrivers: 1 Philips.
1 standard.
1 of regleta.
- Pointed pliers for elastic rings.
- Level.
- Plumb bob.
- Nylon mave.